

CAREFULLY READ THE INSTRUCTIONS BEFORE INSTALLING

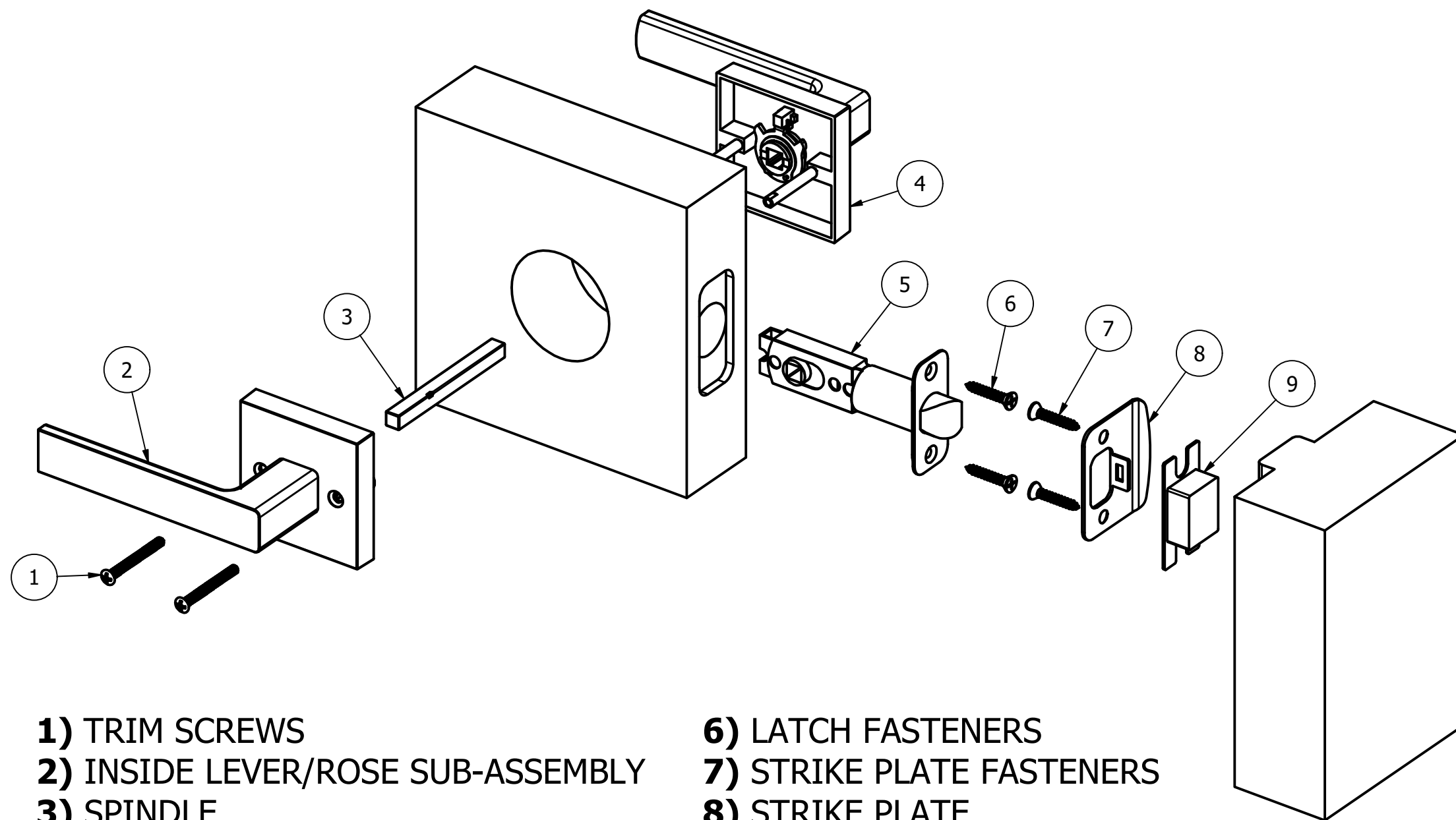

- |                                    |                           |
|------------------------------------|---------------------------|
| 1) TRIM SCREWS                     | 6) LATCH FASTENERS        |
| 2) INSIDE LEVER/ROSE SUB-ASSEMBLY  | 7) STRIKE PLATE FASTENERS |
| 3) SPINDLE                         | 8) STRIKE PLATE           |
| 4) OUTSIDE LEVER/ROSE SUB-ASSEMBLY | 9) DUST BOX               |
| 5) LATCH                           |                           |

### STEP 1)

- A)** PREPARE THE DOOR ACCORDING TO DOOR PREPARATION GUIDE **DP-462**.  
**B)** PREPARE THE STRIKE ACCORDING TO **DP-327** AND INSTALL THE STRIKE PLATE.

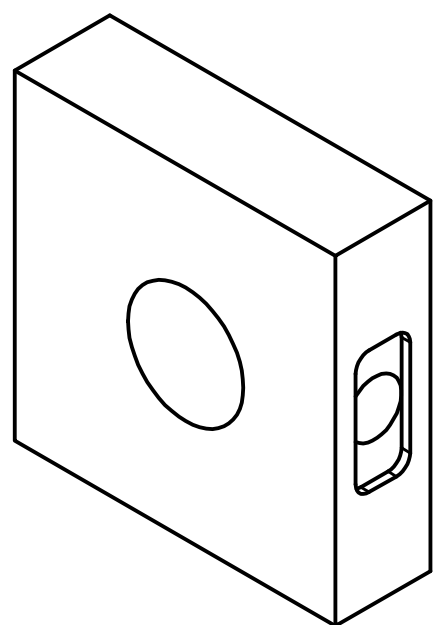

### STEP 2)

- SELECT THE DESIRED LATCH BACKSET BY SLIDING THE SPINDLE HUB, ACCORDING TO THE DOOR PREPARATION, 2-3/8" OR 2-3/4." (SHOWN AT 2-3/4")

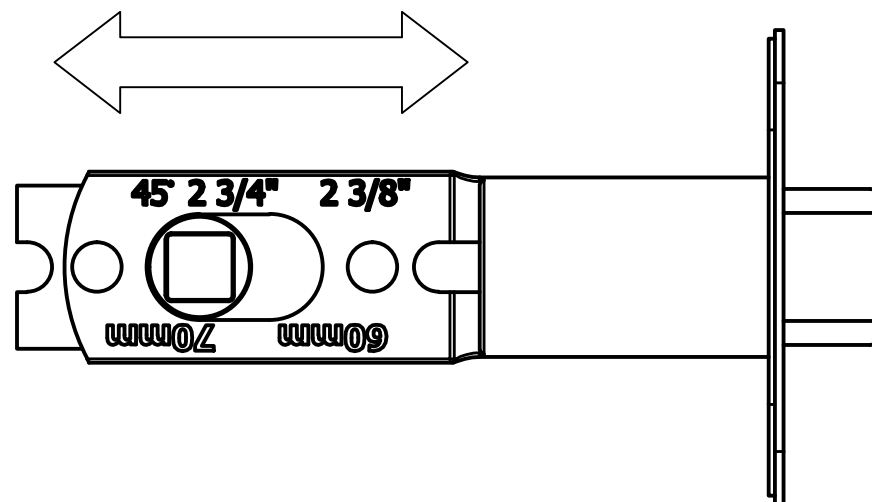

### STEP 3)

- WITH THE LATCH BOLT BEVEL ORIENTED IN THE CORRECT DIRECTION, INSERT THE LATCH (5) INTO THE DOOR AND SECURE IN PLACE WITH THE PROVIDED FASTENERS (6).

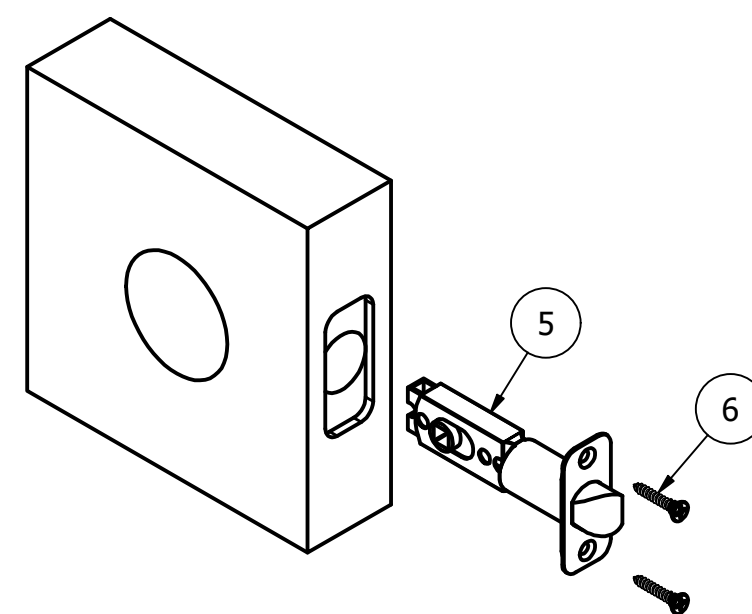

### STEP 4)

- EXAMINE THE SPINDLE (3) AND NOTE THE LOCATION OF THE NOTCHES (B). FROM THE INSIDE OF THE DOOR, FULLY INSERT THE END OF THE SPINDLE THAT IS FARTHEST FROM THE NOTCHES INTO THE SPINDLE HUB OF THE LATCH.

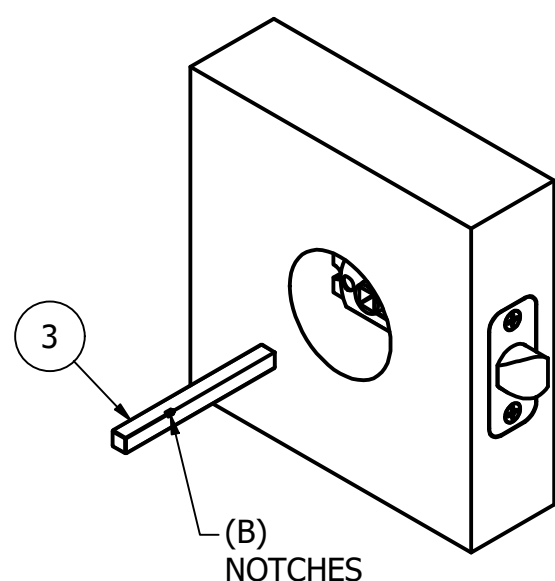

### STEP 5)

- A)** INSERT THE OUTSIDE LEVER (4), WITH THE POSTS GOING THROUGH THE HOLES OF THE LATCH.  
**B)** INSERT THE INSIDE LEVER (2), CAREFULLY ALIGNING THE SCREW HOLES WITH THE POSTS.  
**C)** HOLD THE LEVERS IN THE CORRECT POSITION WHILE FASTENING TOGETHER WITH THE PROVIDED SCREWS (1).

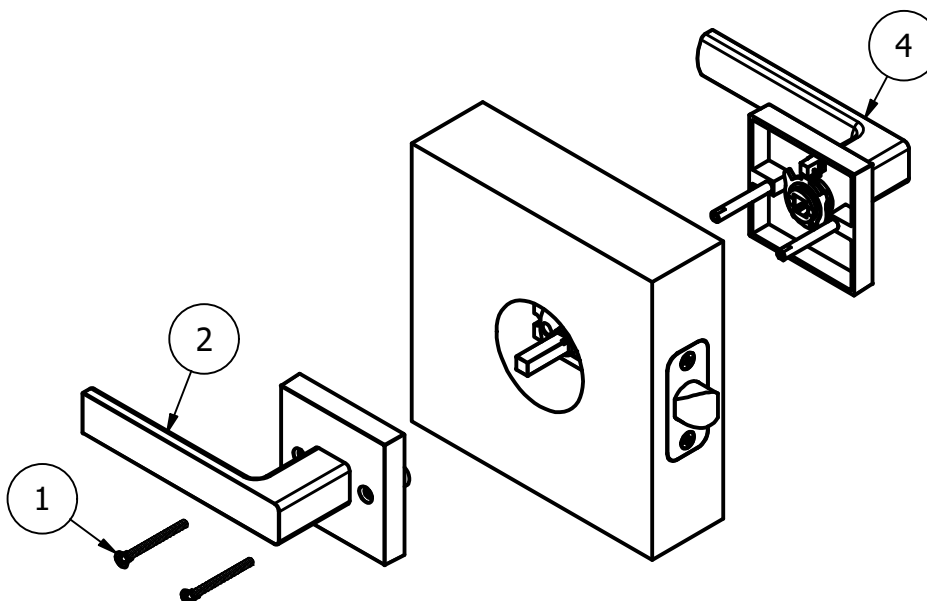

### STEP 6)

- USE THE FOLLOWING STEPS TO CHECK FOR PROPER FUNCTION BEFORE CLOSING DOOR:  
**A)** ROTATE EACH LEVER TO VERIFY THAT THE LATCH BOLT RETRACTS.  
**B)** VERIFY THAT THE LATCH BOLT ENGAGES THE STRIKE WHEN THE DOOR IS CLOSED.

