



DPC1001

Straight, Metro Door Pull



Standard Finishes:

- 625
- 626
- 613
- 605
- 606
- 609
- 619
- 622
- Consult factory for additional finish options

Material:

Brass or Stainless Steel

Pairs with 270 Metro Lever and 6210 Base Lever

Ordering:

Specify CTC and overall length

Additional Information:

Maximum Length: 60"

Size Information:

D: 1.10" (28mm)

D1: .75" (19mm)

C: Per Project Specification

F: 3.11" (79mm)

L: Per project Specification

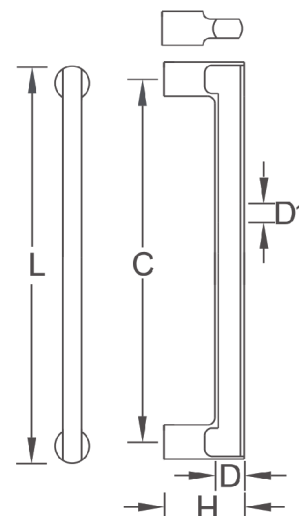

Scan Here For



Frascio Architectural
Door Pull Catalog