



DPA1066

Straight, Round Door Pull

PULLS



Standard Finishes:

- 630
- 629
- 622
- 695

Optional Finishes:

- 605
- 606
- 609
- 619
- Consult factory for additional finish options

Material:

Stainless Steel, Brass

Ordering:

□ □ □ □ □ □ □ □ □ □

Additional Information:

One Size Only

Size Information:

- D: .87" (22 mm)
- D1: .63" x .87" (16mm x 22mm)
- C: 8.86" (225mm)
- E: 2.56" (65mm)
- R: 2.95" (75mm)
- L: 9.72" (247mm)

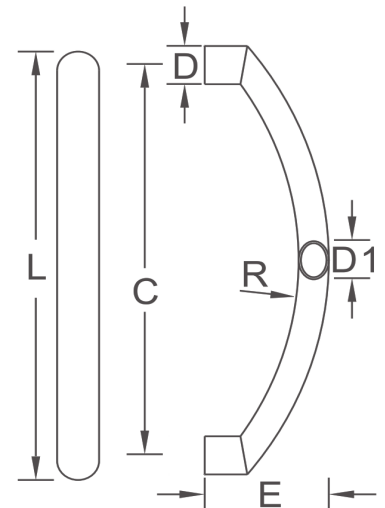

Scan Here For



Frascio Architectural
Door Pull Catalog