

**STEP 1)**  
 A. PREPARE THE DOOR USING DOOR PREP GUIDE, DP-320.  
 B. APPLY THE FIRE DOOR GUARD "F" TO THE INTERIOR SIDE OF LOCK CASE. ATTACH THE FIREDOOR GUARD ALIGNING THE SCREW SLOTS WITH THE THRU HOLES IN THE LOCK CASE. REMOVE THE TAPE COVER TO EXPOSE THE ADHESIVE AND "CAREFULLY" ALIGN AND ADHERE TO INTERIOR SIDE OF LOCK CASE, BEING CAREFUL TO NOT COVER THE THRU HOLES FOR THE FASTENERS.  
 C. INSERT THE LOCKCASE "G" INTO THE DOOR CAVITY AND SECURE WITH THE FASTENERS "H".  
 D. INSERT BOTH INSIDE AND OUTSIDE SPINDLES "C" INTO THE LOCKCASE LEVER HUBS.  
 E. INSERT THE OUTSIDE BACKPLATE "K" INTO THE APPROPRIATE MOUNTING HOLES AND PRESS UP AGAINST DOOR SURFACE. INSTALL THE INSIDE BACKPLATE "D" OVER THE SPINDLE. INSERT THE 2 MOUNTING SCREWS "E" AND TIGHTEN SECURELY TO THE DOOR. DO NOT OVER-TIGHTEN.

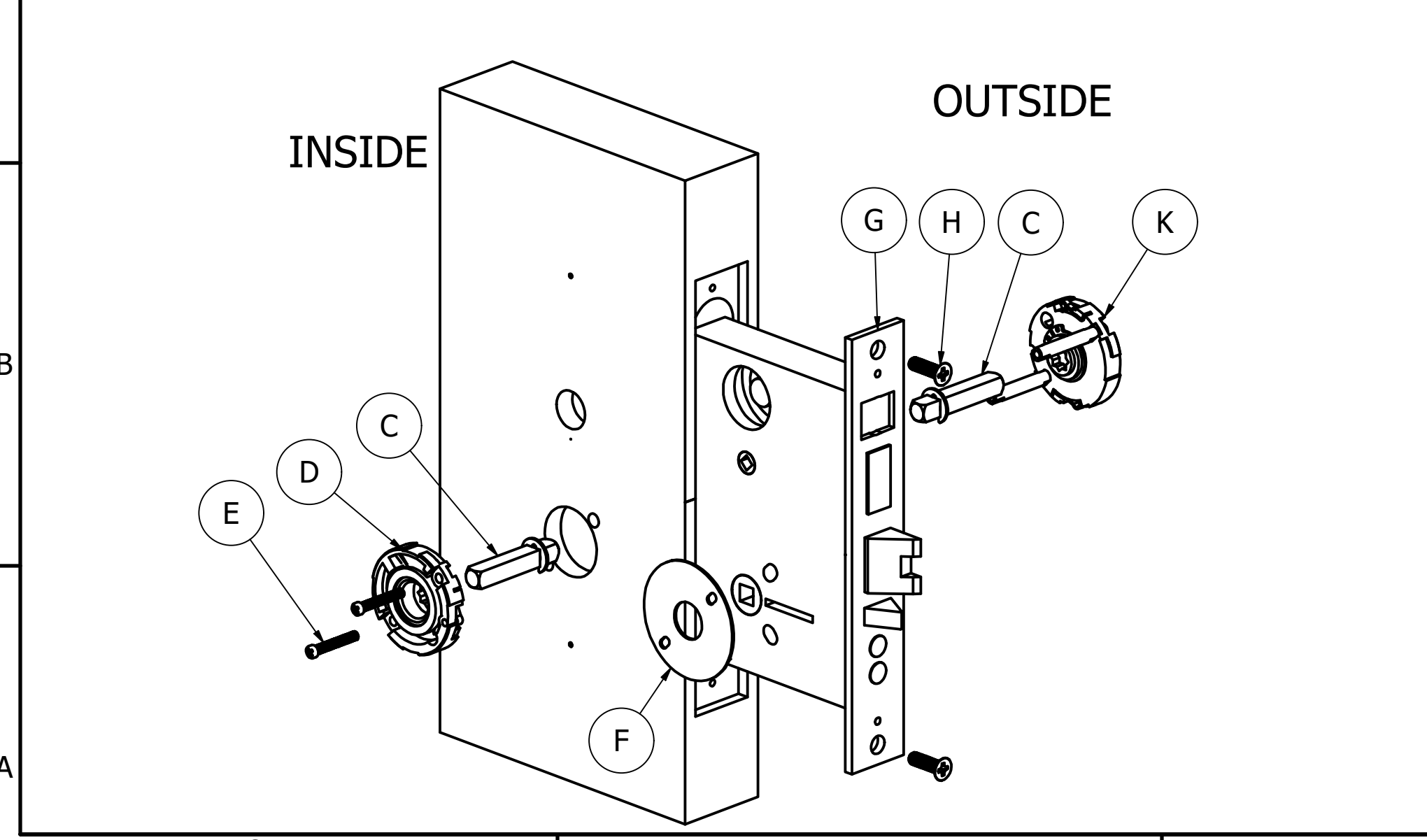

**STEP 2)**  
 A. POSITION THE INSIDE TURN KNOB IN THE VERTICAL POSITION ON THE INSIDE TRIMPLATE SUB-ASSY.  
 B. INSERT THE INSIDE LEVER/TRIMPLATE SUB-ASSY "A" OVER THE LEVER SPINDLE "C".  
 C. ALIGN THE TURN KNOB SPINDLE INTO THE TURN KNOB HUB ON THE LOCK CASE. PUSH TRIM SUB-ASSY UP AGAINST THE SURFACE OF THE DOOR.  
 D. MAKING SURE THE PLATE IS SQUARE-PARALLEL TO THE SURFACE, MARK AND PRE-DRILL THE 2X SURFACE MOUNT SCREWS. INSTALL THE SCREWS "B" ONCE THE HOLES ARE DRILLED.

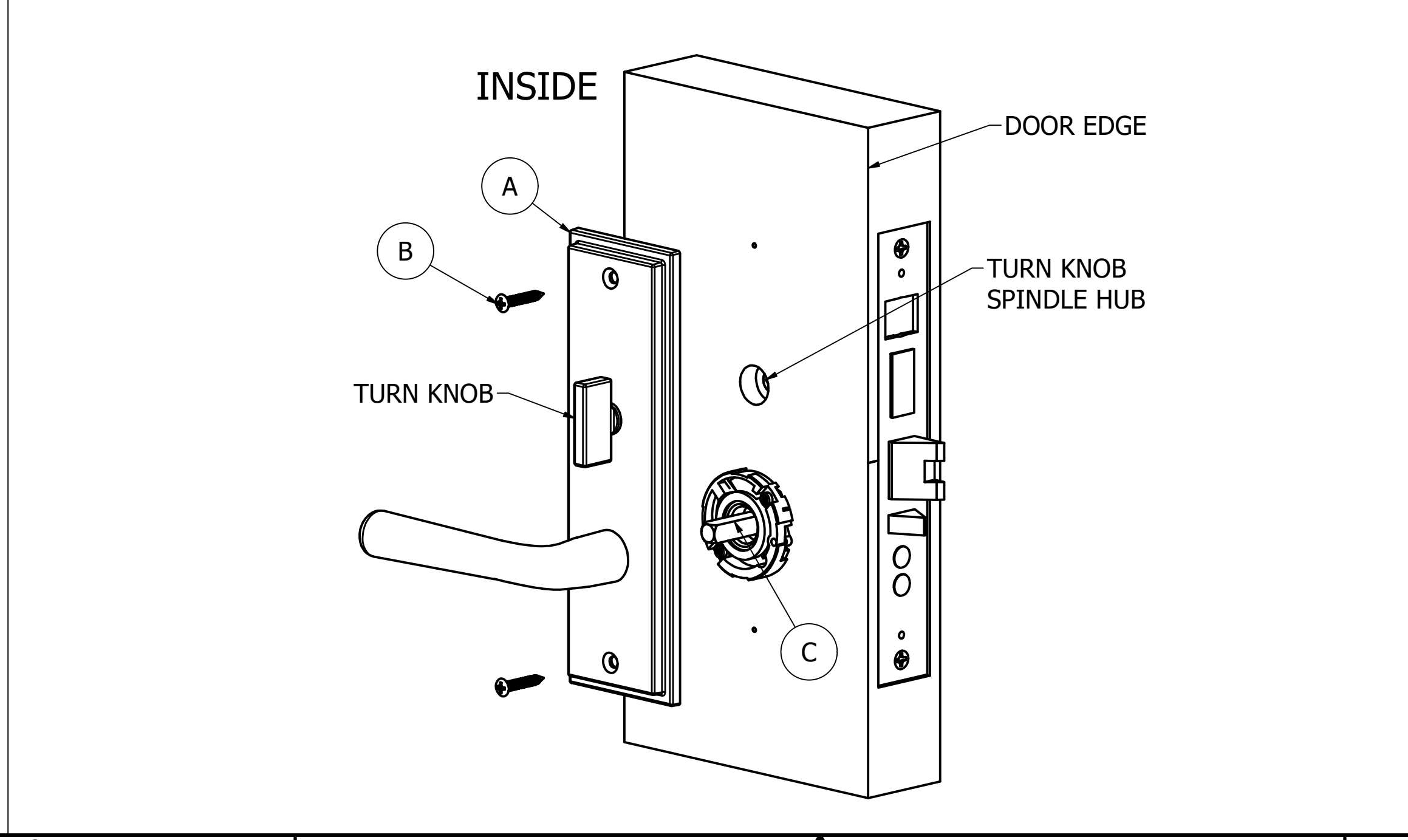

Description:  
**M500 x SURFACE MOUNT FULL PLATE TRIM, INSTALLATION INSTRUCTIONS**



Drawing No: <b>IT-320</b>	
Drawn By: <b>JWB</b>	Orig.Date <b>02-10-25</b>
Rev. Date:	Rev.:

**STEP 3).**  
 A. INSERT THE OUTSIDE LEVER/TRIMPLATE SUB-ASSY "L" OVER THE SPINDLE "C", MAKE SURE LEVER IS HORIZONTAL.  
 B. PUSH TRIM SUB-ASSY UP AGAINST THE SURFACE OF THE DOOR.  
 C. MAKING SURE THE PLATE IS SQUARE-PARALLEL TO THE DOOR EDGE, MARK AND PRE-DRILL THE 2X SURFACE MOUNT SCREW HOLES. RE-INSTALL THE TRIM AND INSERT SCREWS ONCE THE HOLES ARE DRILLED.  
 D. ALIGN AND INSERT THE CYLINDER "M" INTO THE LOCKCASE, THREADING BY HAND AS FAR AS POSSIBLE. USING A FLAT BLADE SCREW DRIVER, INSERT THE BLADE INTO THE KEYWAY AND FINISH THREADING CYLINDER INTO PLACE UNTIL THE CYLINDER BOTTOMS OUT IN THE COUNTER-BORED HOLE. IF KEYWAY IS NOT VERTICALLY ALIGNED REVERSE CYLINDER ROTATION UNTIL THE KEYWAY IS IN THE VERTICAL POSITION (LESS THEN 1 TURN). BE CAREFUL TO NOT OVER-TIGHTEN THE CYLINDER.  
 E. ONCE THE KEYWAY IS IN THE CORRECT VERTICAL POSITION, TAKE A CROSS-RECESSED SCREWDRIVER AND TIGHTEN THE CYLINDER SCREW. MAKE SURE THE CYLINDER IS FIXED BY TAKING THE KEY AND OPERATING THE LOCK CASE.  
 F. ONCE THE LOCKSET OPERATION HAS BEEN TESTED, INSTALL THE FACEPLATE "I" WITH THE 2X FASTENERS "J".

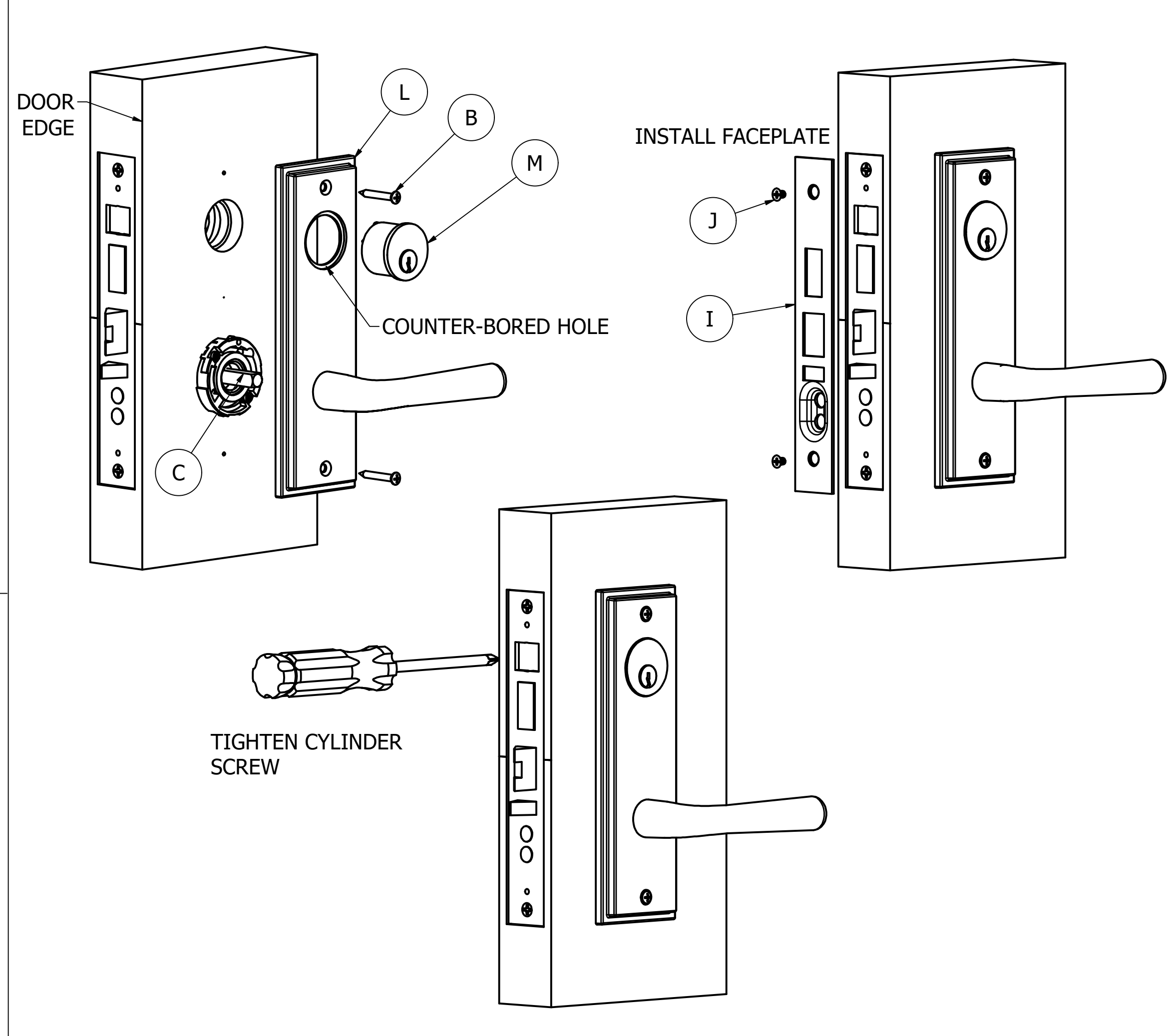

**STEP 4)**  
 A. INSERT THE LEVER SET SCREWS INTO BOTH THE INSIDE AND OUTSIDE LEVERS.  
 B. FIRMLY TIGHTEN THE SET SCREWS WITH SUPPLIED HEX WRENCH.

