

# M500 LOCK SERIES, ESCUTCHEON TRIM, USING 1919 BACKPLATE SPRING SYSTEM, INSTALLATION INSTRUCTIONS

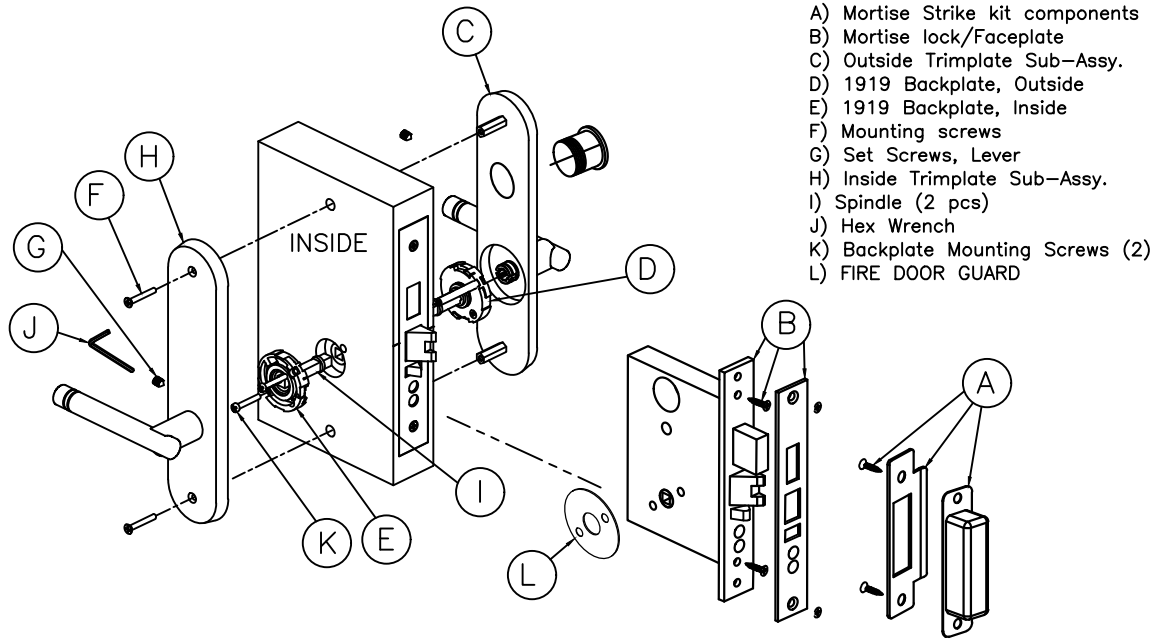

- A) Mortise Strike kit components
- B) Mortise lock/Faceplate
- C) Outside Trimplate Sub-Assy.
- D) 1919 Backplate, Outside
- E) 1919 Backplate, Inside
- F) Mounting screws
- G) Set Screws, Lever
- H) Inside Trimplate Sub-Assy.
- I) Spindle (2 pcs)
- J) Hex Wrench
- K) Backplate Mounting Screws (2)
- L) FIRE DOOR GUARD

BEFORE ASSEMBLING, CAREFULLY READ THE INSTALLATION INSTRUCTIONS.

- STEP 1)**
- a. PREPARE THE DOOR USING DP-202 DOOR PREP GUIDE.
  - b. APPLY THE UL FIREDOOR GUARD "L" ONTO THE LOCK CASE CAREFULLY ALIGNING THE MOUNTING HOLES.
  - c. INSERT THE MORTISE LOCKCASE INTO THE PREPARED CAVITY, THEN INSERT THE RETAINING SCREWS.
- (NOTE: IF USING A KEYED CYLINDER DO NOT INSTALL THE FACEPLATE.)

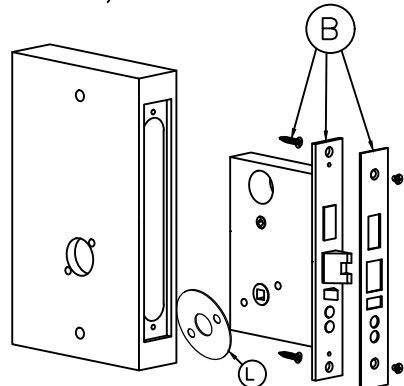

- STEP 2)**
- a. INSERT THE LEVER SPINDLES "I" INTO THE MORTISE LOCKCASE—BOTH INSIDE AND OUTSIDE.
  - b. INSERT THE OUTSIDE 1919 BACKPLATE "D" OVER THE SPINDLE. INSERT THE INSIDE 1919 BACKPLATE "E" OVER THE INSIDE SPINDLE THEN INSERT (2) MOUNTING SCREWS "K". DO NOT OVER TORQUE SCREWS AS THIS COMPRESSES THE DOOR AND MAY CAUSE OPERATIONAL RESTRICTIONS.

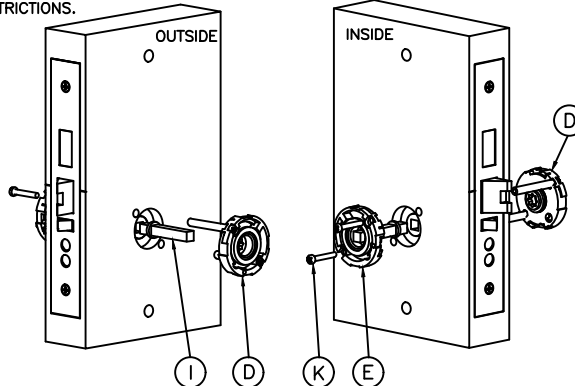

- STEP 3)**
- a. INSTALL THE OUTSIDE TRIM BY ALIGNING THE SQUARE SPINDLE INTO THE SQUARE LEVER HOLE, THEN INSERTING THE 2 POSTS INTO THE APPROPRIATE DRILLED HOLES. PUSH TO SURFACE OF DOOR.
  - b. INSTALL THE INSIDE TRIM BY ALIGNING THE SQUARE SPINDLE INTO THE SQUARE LEVER HOLE, THEN PUSHING TO SURFACE OF DOOR.
  - c. INSERT THE MOUNTING SCREWS AND WHILE HOLDING THE OUTSIDE TRIM TIGHTEN SCREWS INTO THE OUTSIDE TRIM POSTS.
  - d. INSERT THE KEYED CYLINDER TO FULL DEPTH, THEN REVERSE ROTATE UNTIL THE KEYWAY IS VERTICALLY ALIGNED. HAND TIGHTENED CYLINDER RETAINING SCREW WITH SCREW DRIVER. (DO NOT USE ELECTRIC DRILL)

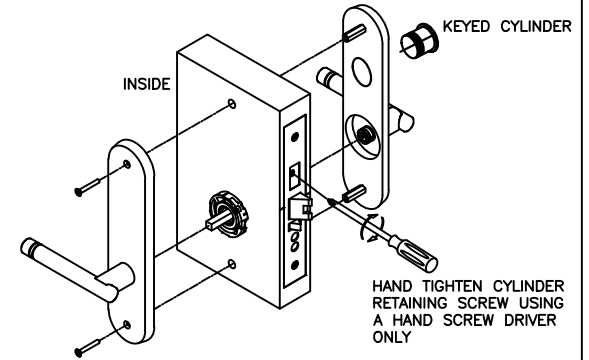

- STEP 4)**
- a. INSERT LEVER SET SCREWS ON BOTH INSIDE AND OUTSIDE LEVERS.
  - b. CHECK LOCKSET OPERATION. LOCKSET AND TRIM SHOULD WORK IN A NORMAL OPERATING MOTION.

