

- 1) TRIM, INSIDE TURN KNOB
- 2) TRIM, OUTSIDE COIN TURN
- 3) TRIM FASTENERS, 2X  
(SELECT CORRECT LENGTH)
- 4) SL-6 LOCK
- 5) FACEPLATE
- 6) FACEPLATE FASTENERS, 3X
- 7) FASTENERS, LOCK CASE, 2X
- 8) FASTENERS, STRIKE BOX, 2X
- 9) FASTENERS, STRIKE PLATE, 2X
- 10) STRIKE PLATE
- 11) STRIKE BOX
- 12) SPINDLE: (DOOR THICKNESS)  
1-3/8" DOOR, 23mm LENGTH  
1-3/4" DOOR, 32mm LENGTH

SELECT CORRECT LENGTH FASTENER ACCORDING TO DOOR THICKNESS.  
FOR 1-3/8" DOOR, USE M4 x 20mm OAL F.H.M.S.  
FOR 1-3/4" DOOR, USE M4 x 30mm OAL F.H.M.S.

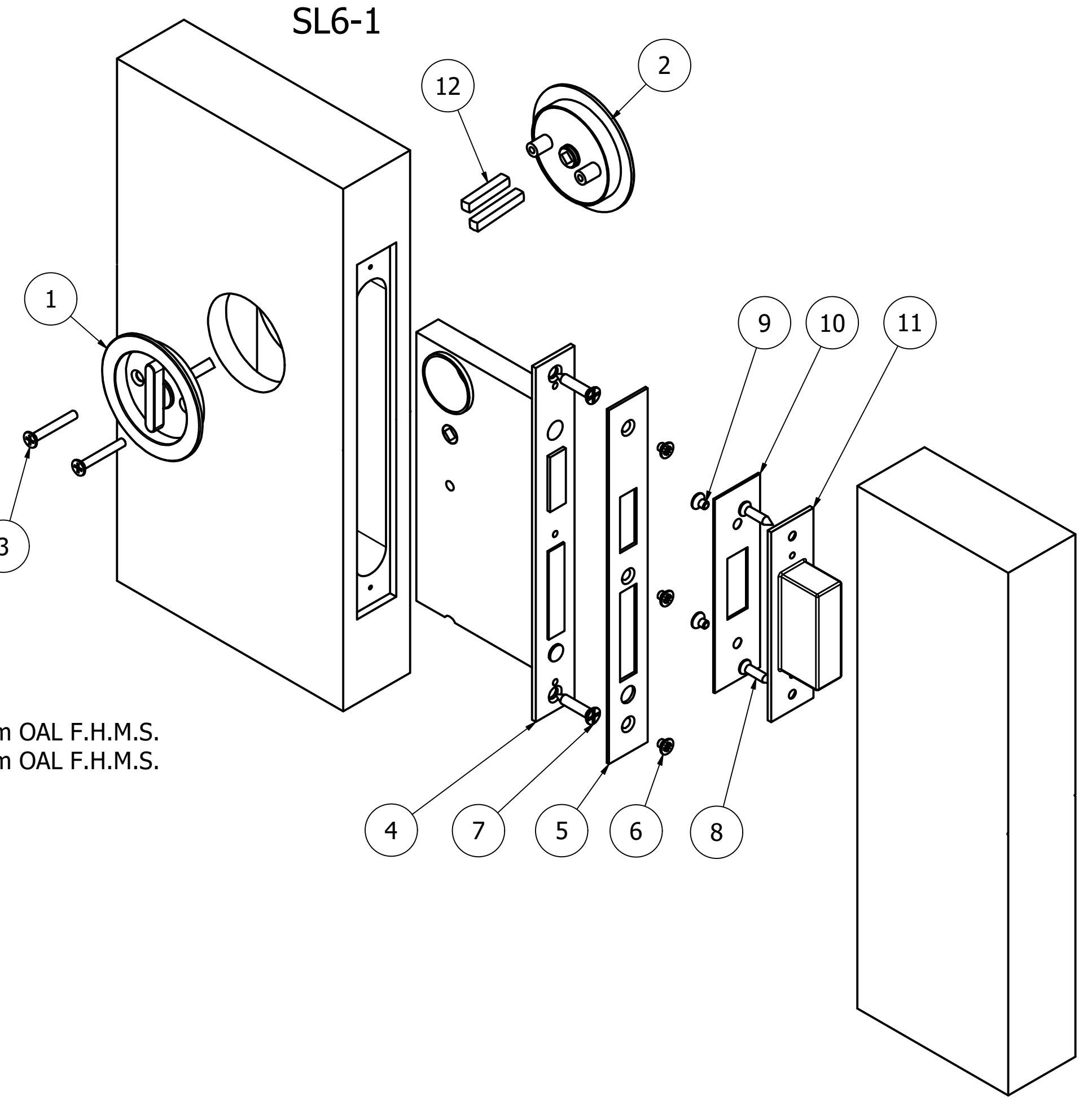

PRIVACY  
RN-1

PASSAGE  
RN-2

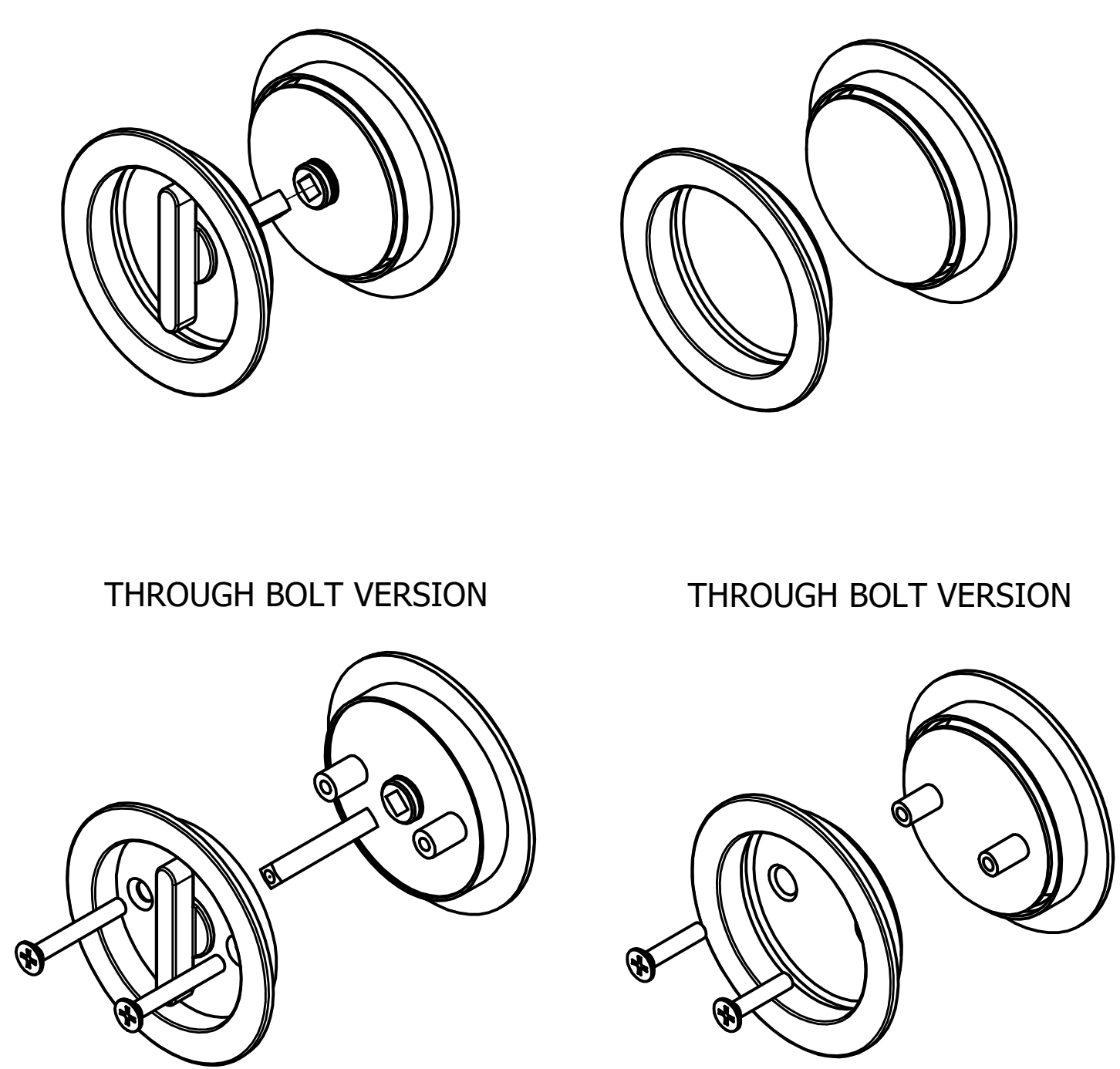

Description:  
SL6 x RN-1, RN-2 TRIM INSTALLATION  
(TRIM SHOWN: SL6 x RN-1)

TOLERANCES UNLESS OTHERWISE SPECIFIED: X.X (METRIC)= ±0.5 X.XX (METRIC)= ±0.15 0.00 (UNIFIED)= ±.015" 0.000 (UNIFIED)= ±.005"	Drawing No: <b>IT-410</b>	
	Drawn By: JWB	Orig.Date 07-21-23
Rev. Date:		Rev.:



**STEP 2B) SILICON ADHESIVE INSTALLATION**  
**A.** LOCATE OUTSIDE "COIN TURN" TRIM SUB-ASSEMBLY (2). ORIENT THE COIN TURN CROSS SLOT IN THE VERTICAL DIRECTION (CASE IS IN UN-LOCKED POSITION). APPLY A SMALL AMOUNT OF CLEAR SILICON ADHESIVE TO THE UNDERNEATH SIDE OF THE TRIM FLANGE. INSERT INTO THE TURN KNOB HUB ON THE LOCKCASE.  
**B.** WITH THE THUMB TURN IN THE VERTICAL POSITION, APPLY A SMALL AMOUNT OF CLEAR SILICON ADHESIVE TO THE UNDERNEATH SIDE OF THE TRIM FLANGE. INSTALL TRIM SUB-ASSEMBLY INTO THE TURN KNOB HUB.  
**C.** CHECK FOR SMOOTH OPERATION OF LOCKSET.  
**D.** IF TRIM IS OPERATING SMOOTHLY, GRASP/PINCH BOTH SIDES OF TRIM TIGHT AGAINST THE DOOR SURFACE. ADD A "C-CLAMP" (WITH PLASTIC FEET OR PROTECTED FEET TO PREVENT SURFACE DAMAGE) TO HOLD IN PLACE UNTIL TRIM ADHESIVE TAKES A SET. AFTER CLAMP IS APPLIED, RECHECK FOR SMOOTH OPERATION. WIPE ANY EXCESS ADHESIVE FROM DOOR SURFACE AND TRIM TO CLEAN THE SURFACES.

**STEP 1)**  
**A.** PREPARE DOOR ACCORDING TO DP-410.  
**B.** INSERT THE LOCK CASE (4) INTO THE EDGE PREP. FOR PRIVACY, SL-1 USE APPROPRIATE LOCKCASE. FOR PASSAGE, SL-2, USE APPROPRIATE LOCKCASE.  
**C.** INSERT THE 2X FASTENERS (7) TO SECURE THE LOCK CASE.  
**D.** ASSEMBLE THE FACEPLATE (5) WITH THE 3X FASTENERS (6).

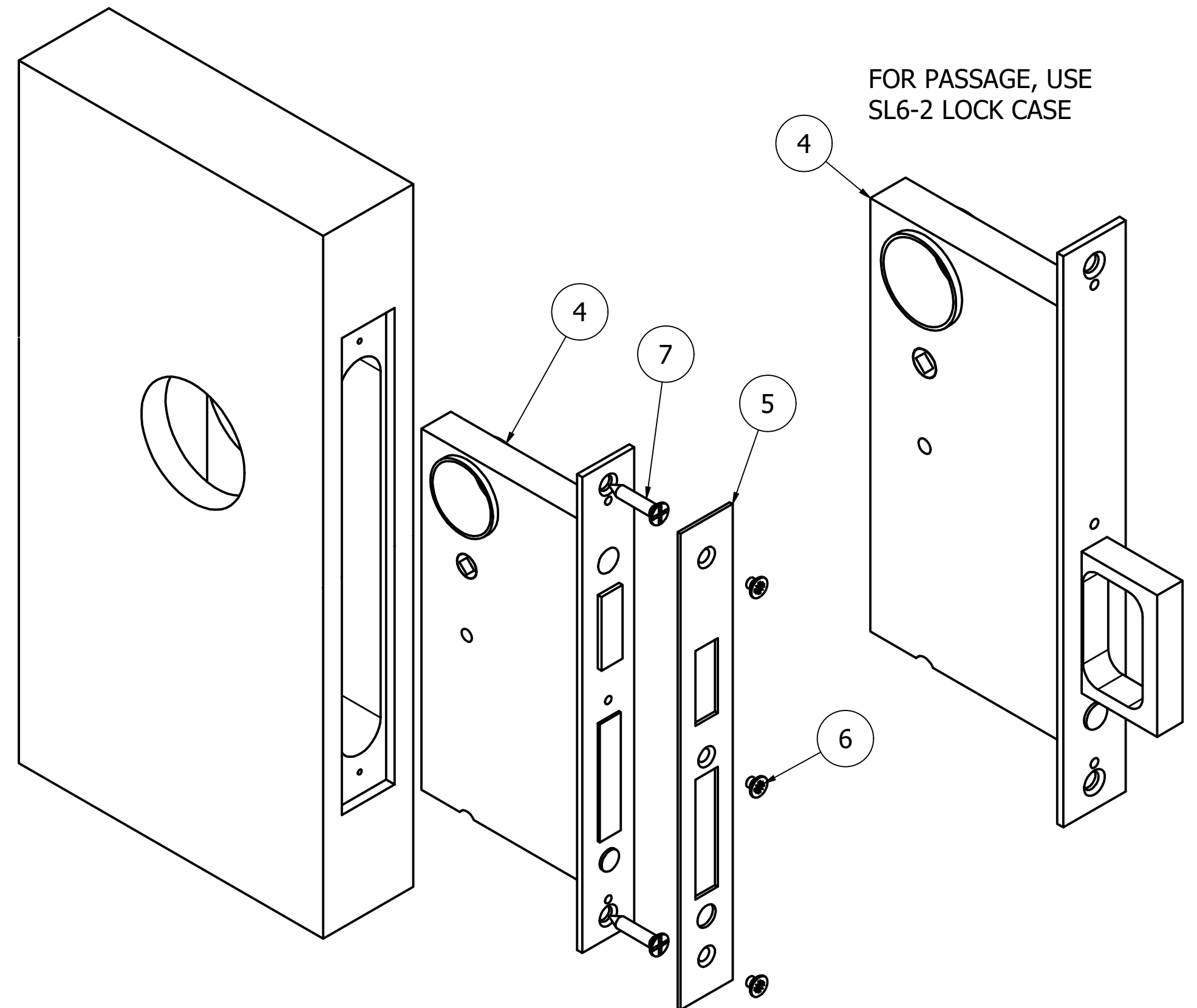

**STEP 2A) THROUGH BOLT INSTALLATION (FOR SILICON INSTALLATION, SEE STEP 2B)**  
**A.** LOCATE OUTSIDE "COIN TURN" TRIM SUB-ASSEMBLY (2). ORIENT THE COIN TURN CROSS SLOT IN THE VERTICAL DIRECTION (CASE IS IN UN-LOCKED POSITION). INSERT INTO THE PREPARED HOLE ON DOOR SURFACE, ALIGNING THE SQUARE SPINDLE HOLE WITH THE TURN KNOB HUB ON THE LOCKCASE.  
**B.** WITH THE THUMB TURN IN THE VERTICAL POSITION, INSTALL THE APPROPRIATE SPINDLE INTO THE TURN KNOB THEN INSTALL TRIM SUB-ASSEMBLY INTO THE TURN KNOB HUB. PRESS AGAINST TRIM TO THE DOOR SURFACE.  
**C.** INSERT THE 2X TRIM FASTENERS (3) TO A LOOSE-TO-SNUG FIT. CHECK FOR SMOOTH OPERATION OF LOCKSET.  
**D.** IF TRIM IS OPERATING SMOOTHLY, GRASP/PINCH BOTH SIDES OF TRIM TIGHT AGAINST THE DOOR SURFACE, THEN TIGHTEN SCREWS. RECHECK FOR SMOOTH OPERATION.  
**E.** IF LOCKSET OPERATION IS TIGHT, LOOSEN TRIM SCREWS AND REPEAT STEP D.

