

STEP 1)
 A. THE DOOR SHOULD BE PREPARED ACCORDING TO DP-386 INSTRUCTIONS. MAKE CERTAIN THE BACKSET IS AT THE CORRECT LOCATION AT EITHER 2-3/8" (60mm) OR 2-3/4" (70mm).
 B. INSERT LATCH "A" INTO THE EDGE BORE MAKING SURE IT IS SEATED FULLY. INSPECT THE LEVER CLEARANCE HOLE AND MAKE SURE LATCH IS CENTERED WITHIN THE BACKSET HOLE.
 C. INSTALL THE LATCH FACEPLATE WITH THE 2X MOUNTING SCREWS.

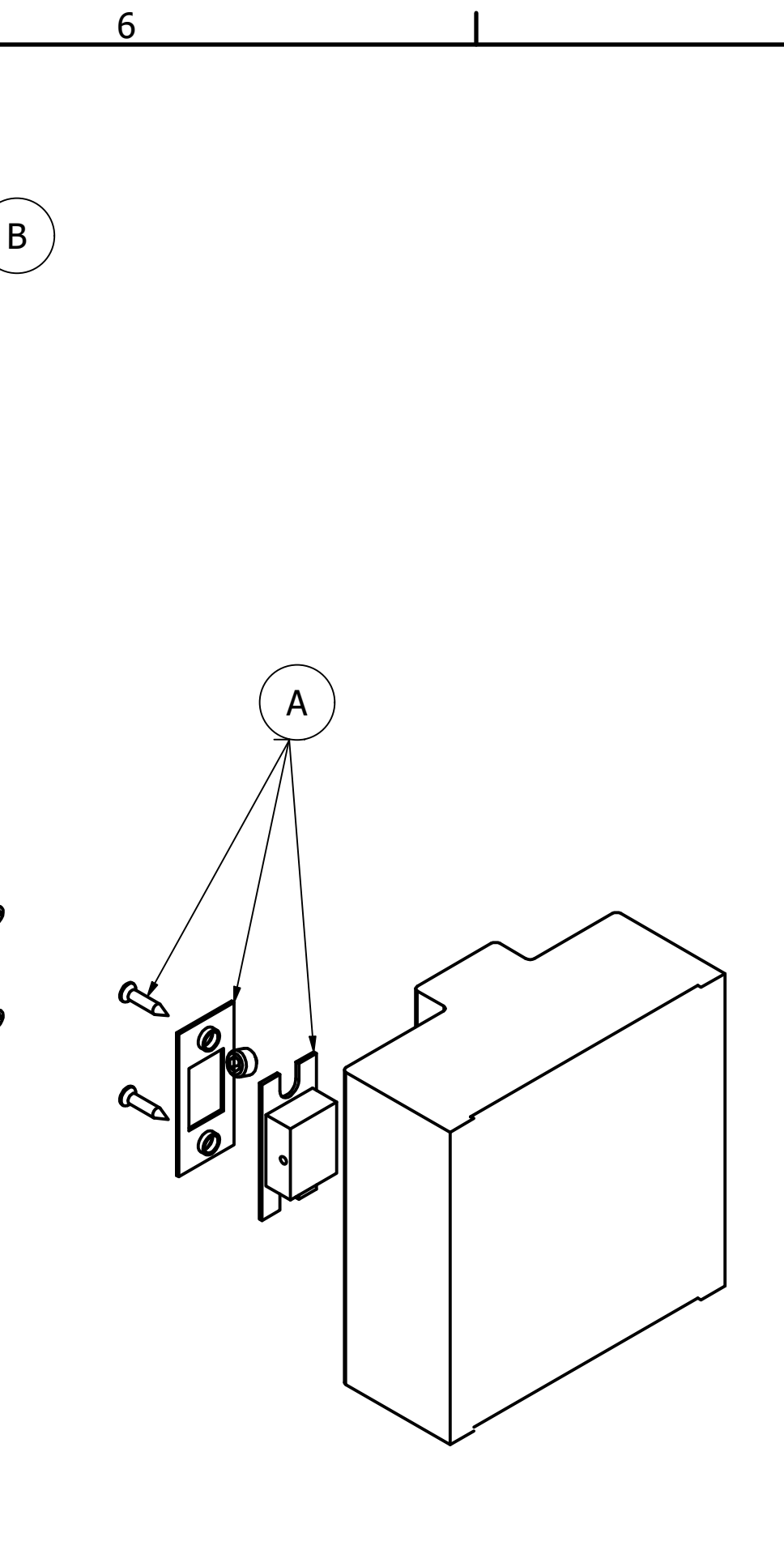

STEP 2)
 A. ORIENT THE SPINDLE "D" SO THAT THE GROOVES/SPLIT ON THE SPINDLE ARE FACING THE LEVER SET SCREW--NORMALLY ON THE INSIDE OF THE LEVER SHANK.
 B. FROM THE INSIDE OF THE DOOR, INSERT THE SPINDLE INTO THE LATCH HUB UNTIL IT IS SEATED AGAINST THE 4 STOPS ON THE SPINDLE.
 C. MAKING SURE THE SPINDLE IS SEATED, FIRMLY PRESS ON THE RETAINING CLIP "C" OVER THE OUTSIDE OF THE SPINDLE. PUSH THIS CLIP UP FIRMLY AGAINST THE LATCH. THE SPINDLE MUST NOT FLOAT ONCE THIS CLIP IS INSTALLED. IF THIS CLIP IS NOT SEATED PROPERLY, THIS COULD CAUSE THE LATCH TO FAIL DURING OPERATION.

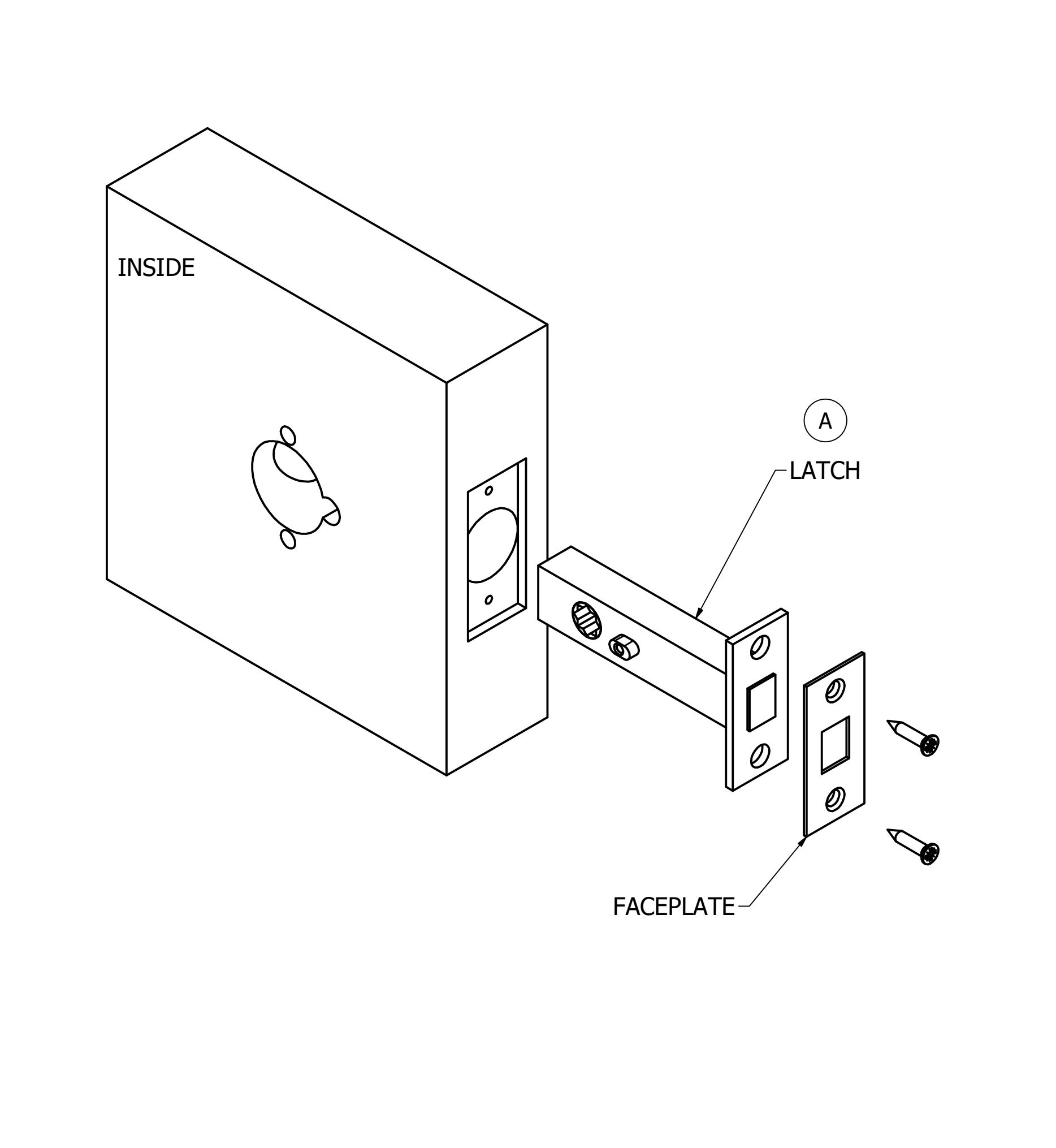
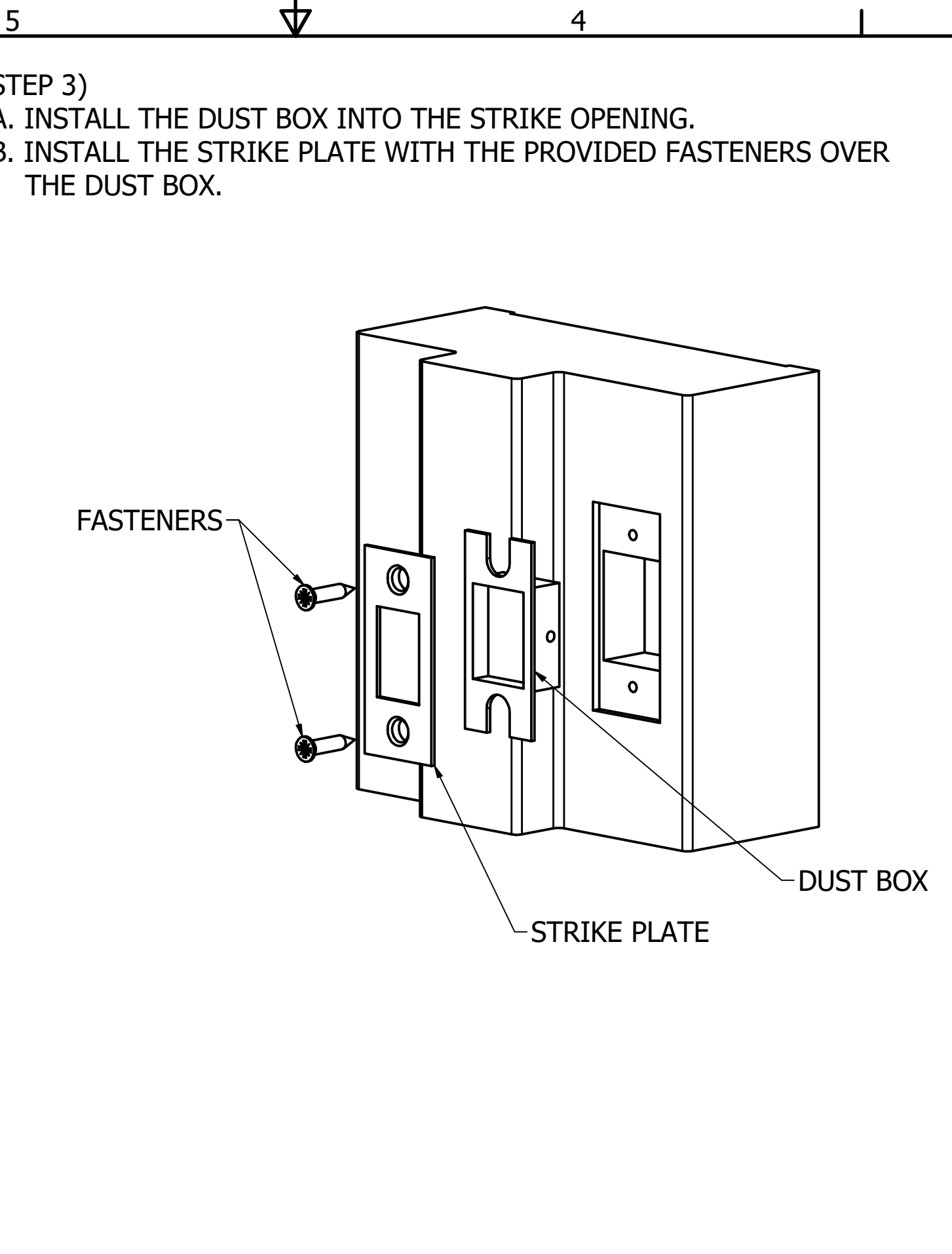
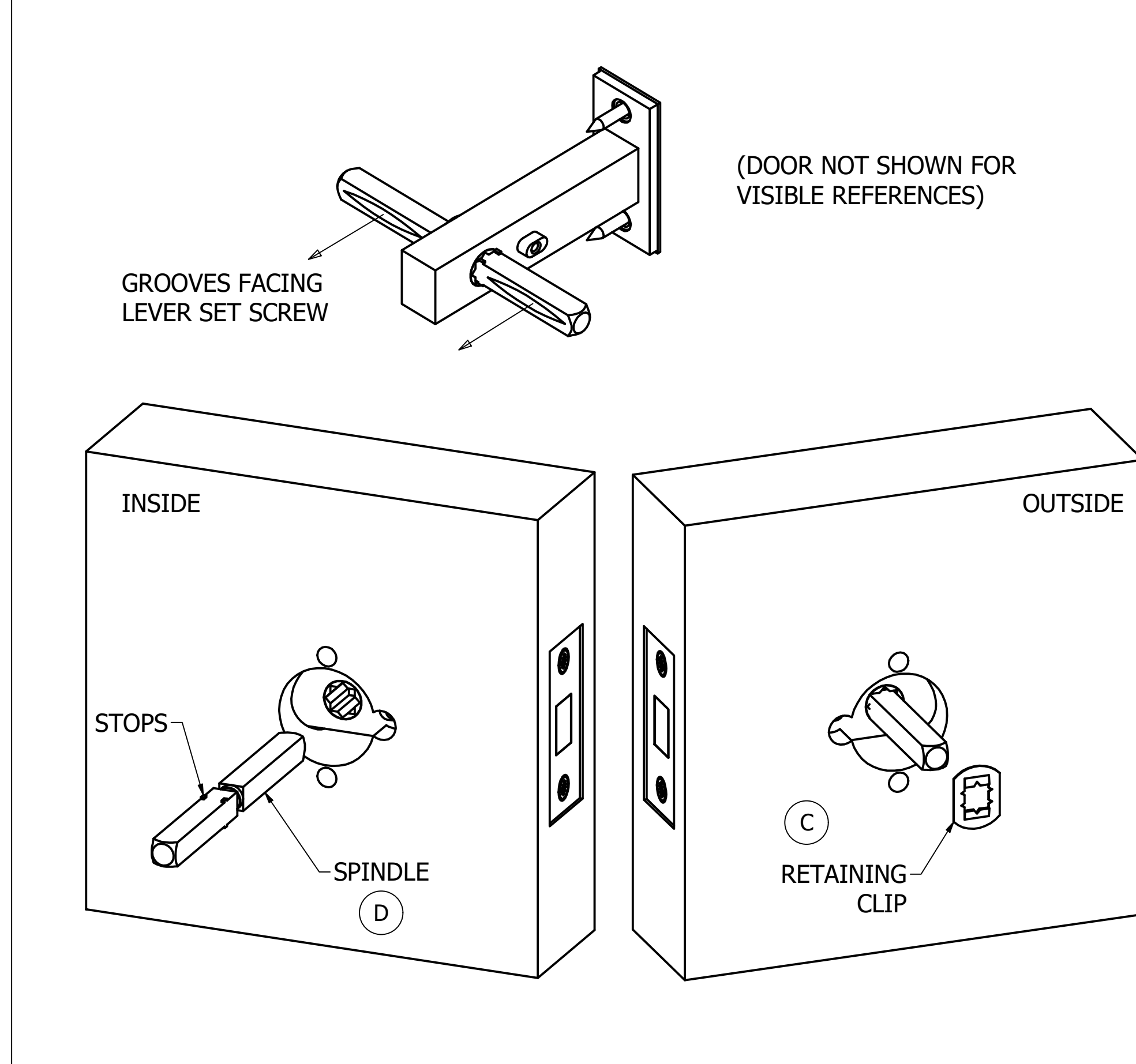

STEP 3)
 A. INSTALL THE DUST BOX INTO THE STRIKE OPENING.
 B. INSTALL THE STRIKE PLATE WITH THE PROVIDED FASTENERS OVER THE DUST BOX.

Description:
RML/T700 TRIM INSTALLATION INSTRUCTIONS (PRIVACY SHOWN)

FR International
 1011 3rd Avenue S.W. Carmel, IN. 46032

Drawing No: IT-386	
Drawn By: JWB	Orig. Date 06-09-22
Rev. Date:	Rev.:

STEP 4)
 A. INSTALL THE OUTSIDE TRIM ASSEMBLY "B" BY ALIGNING THE 2 MOUNTING POSTS WITH THE 2 HOLES IN THE DOOR AND WHILE HOLDING THE LEVER HORIZONTAL, INSERT OVER THE SPINDLE AND PRESS UP AGAINST THE DOOR SURFACE.
 B. INSERT THE INSIDE BACK PLATE ASSEMBLY "H" OVER THE SPINDLE. PRESS UP AGAINST THE DOOR SURFACE AND INSERT THE 2X FASTENERS. TIGHTEN FIRMLY--NOTE: DO NOT OVER TORQUE TO PREVENT PUTTING TRIM IN A BIND.
 C. WITH THE INSIDE LEVER HORIZONTAL AND THE ROSE ORIENTED CORRECTLY WITH THE PRIVACY HOLE IN THE CORRECT LOCATION (SLIGHTLY ABOVE HORIZONTAL) PRESS TRIM AGAINST DOOR SURFACE.

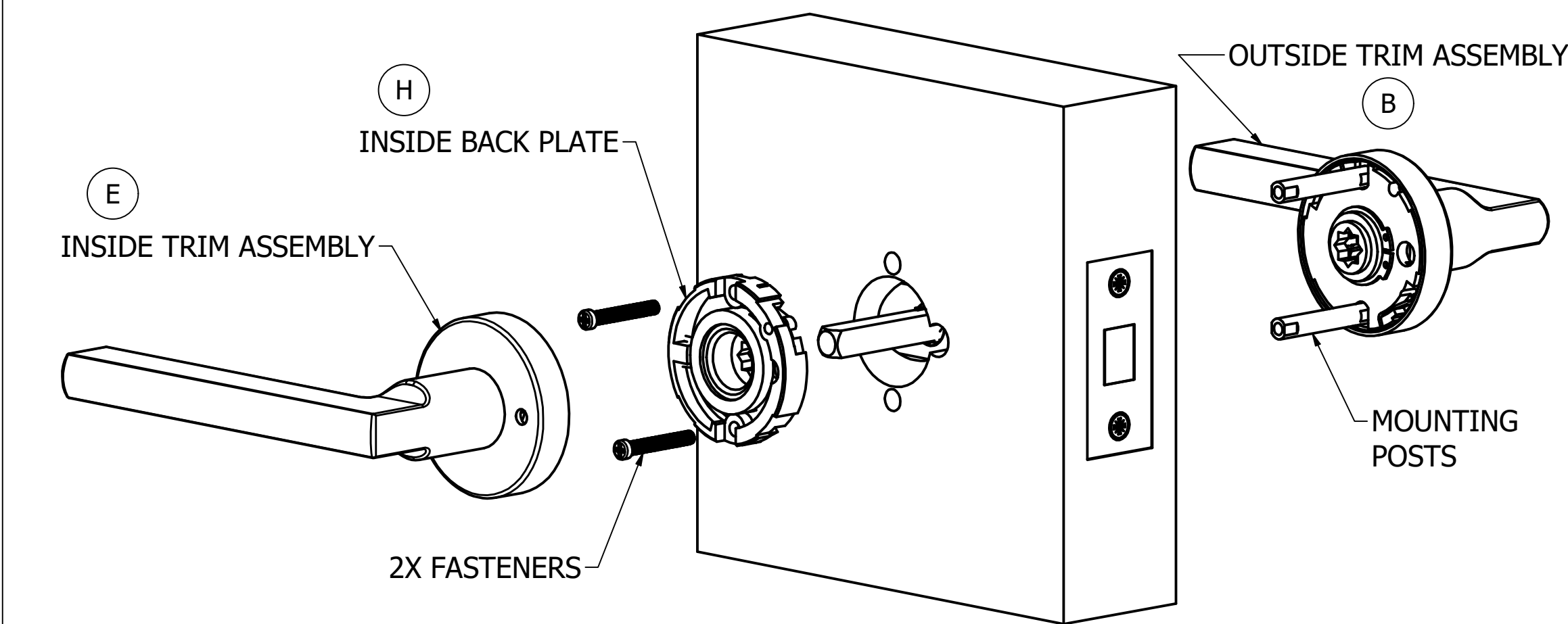

STEP 5)
 A. USING THE PROVIDED STRAP WRENCH, POSITION THE STRAP WRENCH OVER THE ROSE AND TIGHTEN THE STRAP.
 B. ROTATE CLOCKWISE APPROXIMATELY 15° UNTIL ROSE NO LONGER TURNS.
 C. REMOVE STRAP WRENCH. (DISREGARD NEXT STEP IF PASSAGE LATCH)
 D. INSERT THE PRIVACY PIN "F" THROUGH THE HOLE IN THE ROSE AND THREAD INTO THE LATCH. TIGHTEN FIRMLY WITH FINGERS.

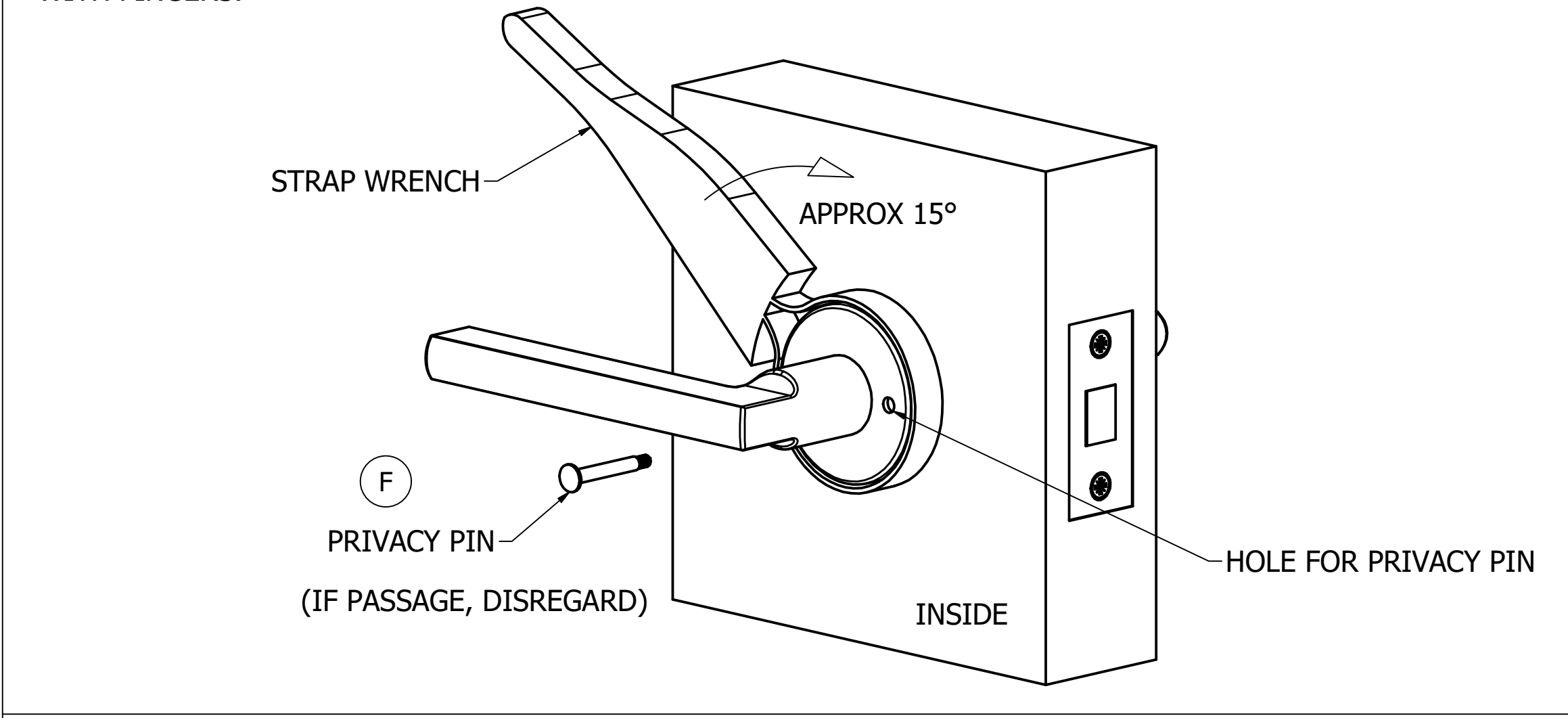

STEP 6)
 A. INSERT THE 2X LEVER SET SCREWS, "I", USING THE PROVIDED HEX WRENCH. TIGHTEN FIRM.

